



# PARKHURST STATE SCHOOL

## PARENTS AND CITIZEN'S ASSOCIATION

### PRINCIPAL'S REPORT – 15/05/2018

#### Current Enrolments

The current effective student enrolment stands at **406** as outlined below. Late last Term, one of our five Year 4/5 Neighbourhood Classes to reflect our Day Eight Staffing Allocation. Since the beginning of this Term, an additional nine learners have enrolled. At the current time, three classes are **on** the maximum class size target, five classes are **approaching** the maximum target and three classes are **over** the maximum target,

Prep	Year 1	Year 2	Year 3	Year 4	Year 5	Year 6	Total
62	56	52	64	59	64	49	406

#### Additional Allocation

In Week One of this Term, an Application for Additional Entitlement was submitted to Regional Office for consideration. The Application was successful to create an additional class to bring class sizes back to or below the maximum class size target. The position has been advertised state wide and there are no applicants available to fulfil the position. Other avenues are being sought to recruit a teacher. Once the position is filled, we will aim to establish an additional Year 4/5 class to take the strain off the other Year 4/5 and 5/6 classes. Like the process of dissolving the class, all parents and carers of affected learners will be contacted personally to advise them of any changes.

#### Staffing Update

This Term, we have welcomed a number of new staff to the school including **Mr Dominic Draper**, replacing **Ms Rebecca Raymont** on Year 4/5. Mr Draper comes to us with a wealth of experience, most recently in the role of NRL Sports Development Officer. We have also welcomed the return of some familiar faces and some new faces as part of our Investing for Success Teacher Aide Team who work with all Prep and Year One learners, providing an opportunity to read to and be read to by an adult. This team comprises **Mr Riley McGuire**, **Mrs Amy Shepherd**, **Mrs Kerri Dolinski**, **Mrs Dayle Bray** and **Mrs Tracey Callaghan**. This team is currently undertaking a comprehensive professional development program, to develop their knowledge and skills to support learners.

#### 2019 Workforce Proposal

All schools are requested to submit detailed Workforce Proposals for 2019 by this Friday. These proposals assist the Region to identify workforce needs in terms of losses, gains and the number of teachers that may be transferred in/out of the Region. This proposal also assists the school and region to identify any specific facility requirements. In 2019, our total anticipated and predicted school enrolment is **428** learners and the establishment of an eighteenth class. This prediction takes into account our Enrolment Management Plan (EMP) and local circumstances. Another additional classroom space will be required.

#### 2019 Enrolments

Last week, the Newsletter communicated the process around 2019 enrolments. As per Parkhurst State School's Enrolment Management Plan, only students whose principal place of residence is within the school's catchment area will be eligible for enrolment at the school. Students who are siblings of current students at the school are eligible for enrolment. We are requesting that younger siblings of students who are eligible for Prep in 2019 complete the Enrolment Forms and lodge with the Office as soon as possible.

## **P&C Documents**

The following is a list of key documents the Region has reminded all Parents and Citizens' Associations to develop and/or refer to. The 2018 Constitution and Student Protection Risk management Strategy have been uploaded to the school's website.

- P&C Constitution (DoE publication)
- Accounting Manual for P&C Associations (DoE publication)
- The P&C Guide (new in 2018)
- Purchasing Policy for P&C Associations (DoE publication)
- P&C Social Media Guide (DoE publication)
- ATO requires P&Cs to have Auskey
- Student Protection Risk Management Strategy

## **P&C Day**

Friday May 25<sup>th</sup> 2018 is Queensland's P&C Day. All schools are encouraged to consider ways to thank their P&Cs for the work they do and the support they give schools. Each year, we recognise our Volunteers as part of National Volunteers Week. All classes are encouraged to recognise and thank the P&C Members and Volunteers during this week.

## **Grounds and Facilities**

In the last week of Term Two, Mrs Hannan's Year 2/3H to relocated D Block. This strategy was to reduce the amount of congestion in A Block and provide additional space. Mrs Hannan and her class are enjoying their new space and the new furnishings and equipment within.

## **Neighbourhood Activities**

Each of our Learning Neighbourhoods have planned a number of curriculum related activities and events occurring throughout Term Two. These include our annual Under Eights' Activity Session, the P/1 Neighbourhood's Excursion to the Pilbeam Theatre as part of their 'Readers' Theatre' Unit and the Year 6 Neighbourhood's Camp to Garapine in Gympie.

## **Conceptual Master Plan Consultation**

Thank you to everyone who took the time to provide feedback to the Central Office facilities and Infrastructure Team regarding the DRAFT conceptual master plan sent home to all families, accompanied by a short survey four weeks ago. This feedback will assist to make decisions regarding priorities and the future stages of development. This process was a substantial undertaking of around \$50 000. A copy of the feedback provided via the survey and social media responses is included in this report.

## **Term Two Upcoming Events and Activities**

Tuesday May 15 <sup>th</sup>	NAPLAN Breakfast NAPLAN : Language Conventions and Writing Parents and Citizens' Meeting
Wednesday May 16 <sup>th</sup>	NAPLAN : Reading
Thursday May 17 <sup>th</sup>	NAPLAN : Numeracy
Friday May 18 <sup>th</sup>	NAPLAN : Test Catch Up Day PAWS Pop Up Shop Opens
Wednesday May 23 <sup>rd</sup>	Simultaneous Reading Day
Friday May 25 <sup>th</sup>	Choir Performance at Romp in the Park Term Three Disco
Tuesday May 29 <sup>th</sup>	P/1 Neighbourhood's '78 Storey Treehouse' Excursion
Wednesday May 30 <sup>th</sup>	Australia's Biggest Morning Tea
Thursday May 31 <sup>st</sup>	Parkhurst State School Book Swap
Monday June 04 <sup>th</sup>	Year Six Camp
Tuesday June 12 <sup>th</sup>	Choir Performance at the Heritage Village
Wednesday June 13 <sup>th</sup>	Sports Day and Under Eights Activity Session
Thursday June 14 <sup>th</sup>	Rockhampton Show Day Holiday
Friday June 15 <sup>th</sup>	Choir Performance at the Rockhampton Show
Tuesday June 19 <sup>th</sup>	Parents and Citizens' Meeting
Friday June 22 <sup>nd</sup>	PAWS Pop Up Shop Opens
Tuesday June 26 <sup>th</sup>	Semester One Report Cards Emailed Home
Friday June 29 <sup>th</sup>	Assembly of Excellence Winter Vacation Commences

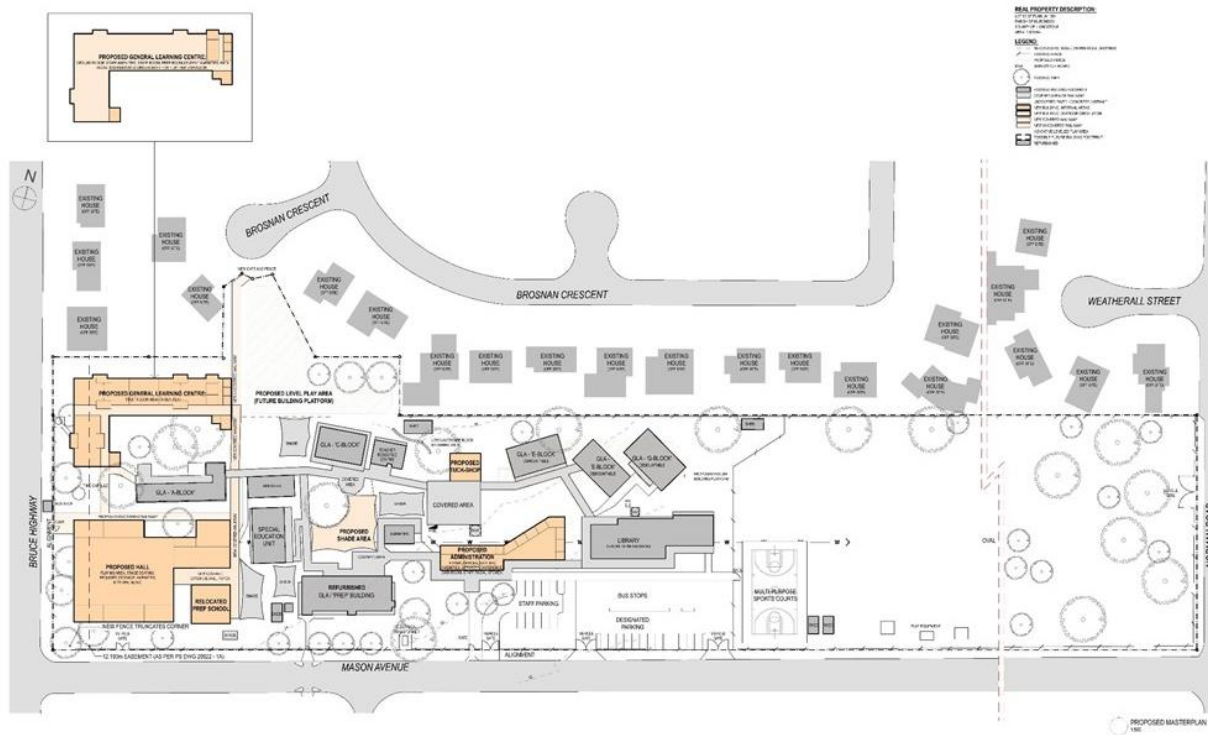

Project Name: PARKHURST STATE SCHOOL MASTERPLAN OPTION 1  
 Client: DEPARTMENT OF EDUCATION  
 Project Address: 11 MASON AVENUE, PARKHURST QLD 4702  
 Drawing Title: PROPOSED MASTERPLAN  
 Status: PRELIMINARY  
 Scale: A1  
 Date: 11/08/2022



# Conceptual Master Plan

## Community Consultation

### Glowing – Good Points and Strengths

- Excellent plan
- Looks good
- Great for our kids
- A brilliant idea
- Looks great
- Looks awesome
- Well thought out
- Plan definitely needed
- Looks fantastic
- Smart use of space
- Great to see Oval has not been reduced
- Covers everything, good use of funding



455 people reached  
 81 views of the plan  
 94 post clicks  
 5 likes  
 2 loves

### Growing – Considerations

- Addition of a Science Lab
- Hall required for all year use
- Air conditioning in Hall
- Indoor sports court in Hall
- New Oval play equipment
- Undercover Area is far too small for 400 kids, staff and parents
- Parents often standing in rain during events
- Extend Covered Play Area
- Access from Brosnan Crescent to School
- Covered walkways to G Block and from Admin to Assembly Area
- Additional General Learning Area will take away from the school's character from Highway
- Improve/increase parking, current vacant lots are 'our' parking
- Increase traffic flow, additional Drop Off Zone
- Provide toilets at 'Senior' end of the school
- Extend Year 2/3 Playground



- 83% Hall (including Music Centre)
- 17% Additional Shade Structures
- 17% Refurbish/Relocate Prep
- 6% New Administration Building
- 6% New General Learning Area
- 6% New Tuckshop



- ### Questions
1. Does the ultimate number of classrooms reflect the school's 'final' size?
  2. Can a vegetable garden or nature trail be established?
  3. Will the Hall be built on the Dental Van site?

### Financial Statement

The most current **Financial Report** for this period, including the **Budget Overview Report** and **Financial Snapshot Report** is attached for minuting.

Lyle Walker  
 PRINCIPAL